



London Road, St Leonards-On-Sea TN37 6AS

Offers in excess of £195,000



A beautifully presented TWO BEDROOM apartment with a COURTYARD GARDEN spanning the lower floor of this period property. It's centrally located just a short stroll from the hub of St. Leonards On Sea, within walking distance to the beach, local shops eateries and Warrior Square mainline railway station which benefits from connections to London. The NEWLY REFURBISHED ACCOMMODATION is accessed via a private entrance and arranged as an OPEN PLAN LIVING SPACE with a large bay window framing a front aspect and complete with a MODERN FITTED KITCHEN. There are two bedrooms together with a stylish shower room. The principal bedroom measures an impressive 19'10 x 14'11 and features a WALK-IN STORAGE CUPBOARD and access to the rear courtyard garden. Being sold with NO ONWARD CHAIN this fantastic property would make the perfect first time home.

LOWER GROUND FLOOR
727 sq.ft. (67.6 sq.m.) approx.

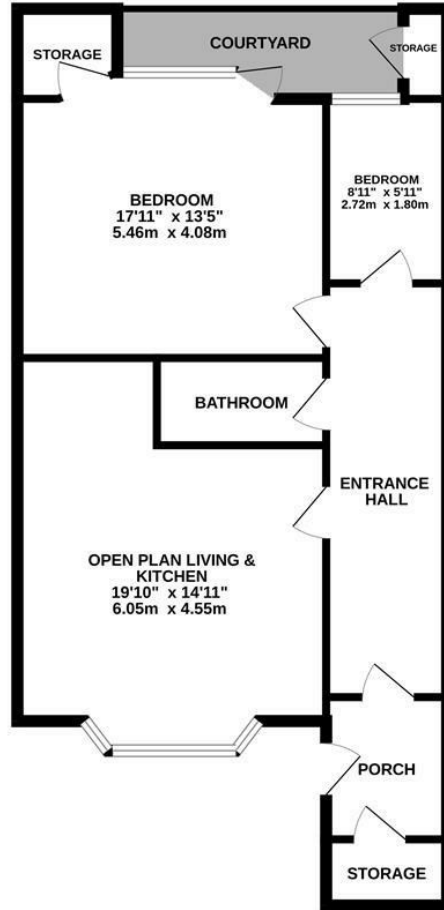

TOTAL FLOOR AREA : 727 sq.ft. (67.6 sq.m.) approx.

Whilst every attempt has been made to ensure the accuracy of the floorplan contained here, measurements of doors, windows, rooms and any other items are approximate and no responsibility is taken for any error, omission or mis-statement. This plan is for illustrative purposes only and should be used as such by any prospective purchaser. The services, systems and appliances shown have not been tested and no guarantee as to their operability or efficiency can be given.
Made with Metropix ©2025

